

This map is reproduced from Ordnance Survey material with the permission of Ordnance Survey on behalf of the Controller of Her Majesty's Stationery Office © Crown copyright. Unauthorised reproduction infringes Crown copyright and may lead to prosecution of civil proceedings. Stockport Metropolitan Borough Council 100019571 2012

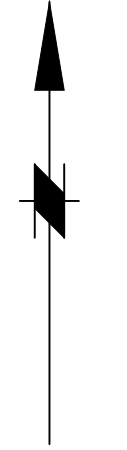

KEY

- PROPOSED CARRIAGEWAY
- PROPOSED CENTRAL RESERVE
- PROPOSED FOOTWAY/SHARED USE FACILITY/ BRIDLEWAY
- PROPOSED FARMERS TRACK
- PROPOSED VERGE
- PROPOSED ENGINEERED EARTHWORKS
- PROPOSED ATTENUATION PONDS
- PROPOSED WATERCOURSE DIVERSION
- PROPOSED STRUCTURE
- EXISTING PUBLIC RIGHTS OF WAY
- EXISTING PUBLIC RIGHTS OF WAY STOPPED UP
- FENCING LEGEND
- PROPOSED 1.8m HIGH ACOUSTIC FENCING REFER TO DETAIL ON DRG
- PROPOSED 3.0m HIGH ACOUSTIC FENCING REFER TO DETAIL ON DRG
- PROPOSED TIMBER POST AND FOUR RAIL FENCING REFER TO STANDARD
- PROPOSED 1.8m HIGH SECURITY FENCE
- PROPOSED 4.0m HIGH BALL STOP MESH FENCE
- PROPOSED TEMPORARY FENCE
- PROPOSED GATE
- PROPOSED STREET LIGHTING COLUMNS

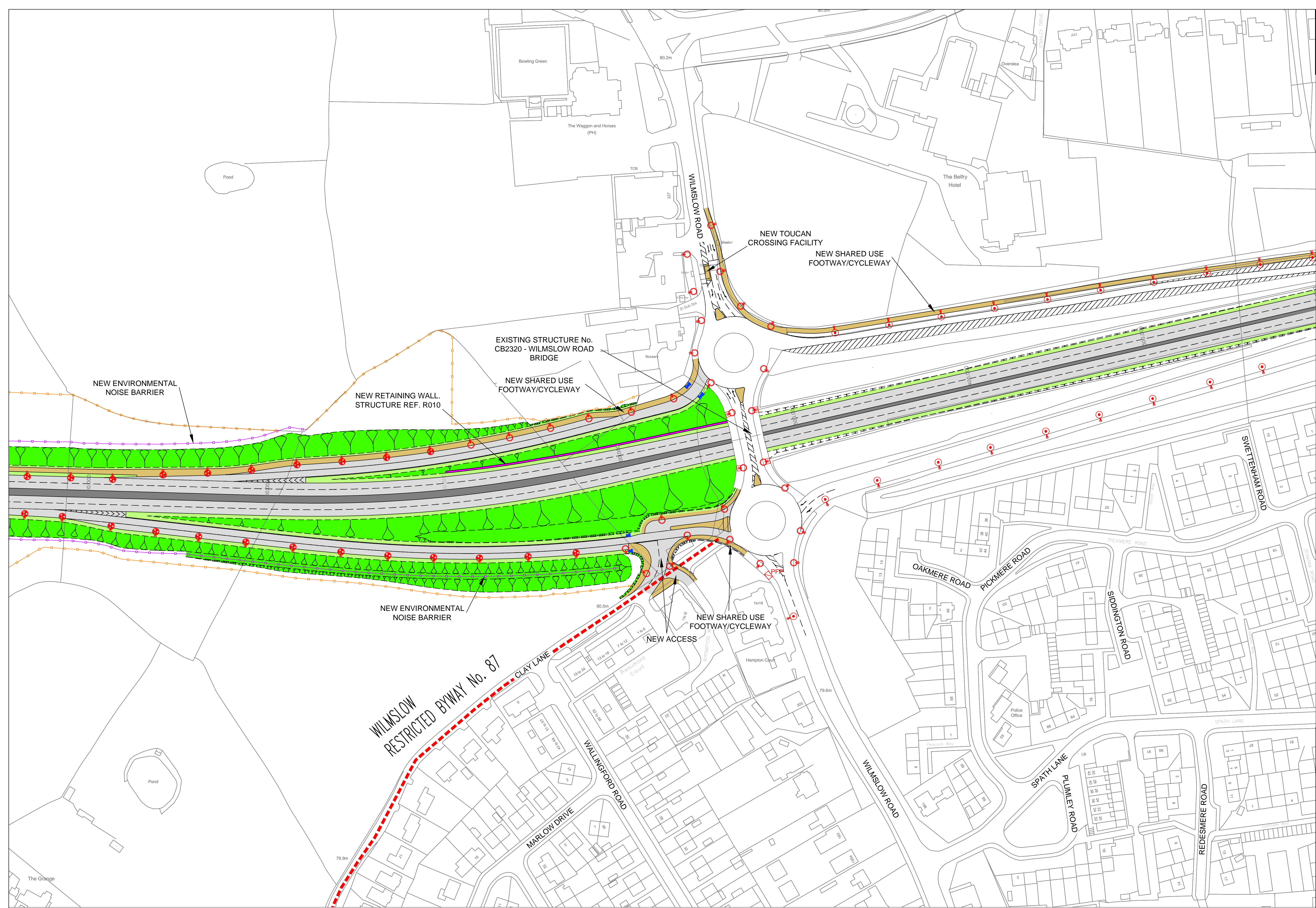

WILMSLOW RESTRICTED BYWAY No. 87

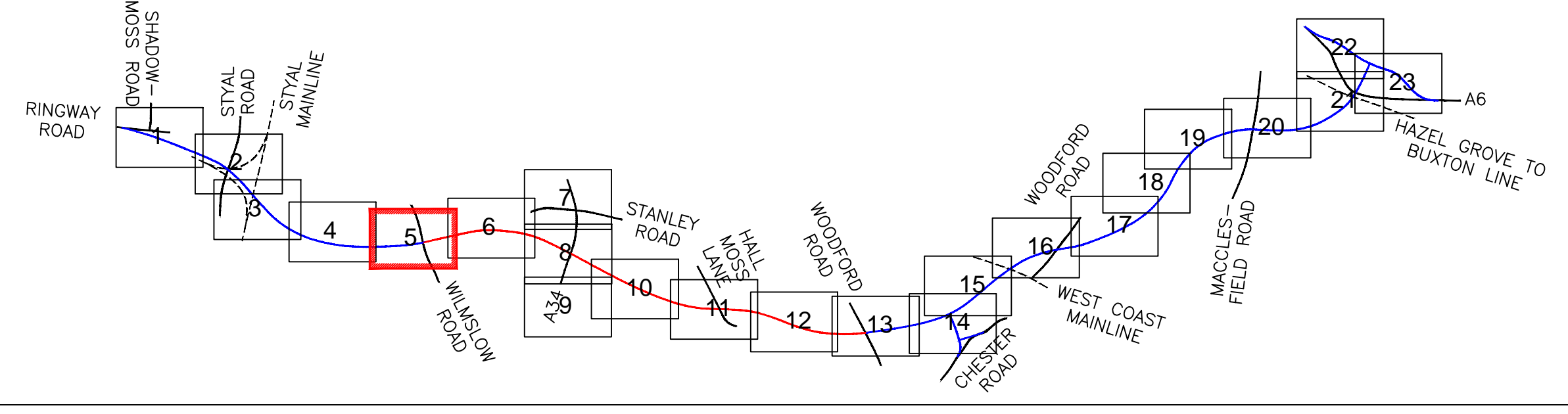

| Rev. | Drawn | Checked | Date | Revision Details |
|------|-------|---------|------|------------------|
| | | | | |

www.semmms.info

Jim McMahon BS: C.Eng. MICE
SERVICE DIRECTOR, MAJOR PROJECTS

STOPFORD HOUSE
STOPFORD ST. SUE
TEL : 0161 474 4351
FAX : 0161 474 4553

Job Title
A6 - MANCHESTER AIRPORT RELIEF ROAD

Drawing Title

**PLANNING APPLICATION
BLOCK PLANS
PROPOSED SHEET 5**

| Drawn | Engineer | Checked | Approved |
|------------------------------|----------|----------|----------|
| SEB/DP | SP | NH | AB |
| Date | Date | Date | Date |
| 03.10.13 | 03.10.13 | 03.10.13 | 03.10.13 |
| Size | Scale | | |
| A1 | 1:1000 | | |
| SCG No. | Filename | | |
| | | | |
| Drawing No. | | | |
| 1007/3D/DF7/A6-MA/PABP/P/027 | | | |

Revision