

NOTES:

1. This drawing has been produced based on the latest MX highway model – Draft Design Freeze 7, as provided by the client.
2. This drawing has been produced mainly for the purpose of planning application.
3. Only one option has been considered for this location as per client's instructions.
4. Levels are in meters and above Ordnate Datum.
5. All dimension are in millimeters.
6. The option shown on this drawing is based on the latest available geotechnical information.
7. Basic preliminary design has been undertaken to determine the geometry of the section sizes as per client's instruction.

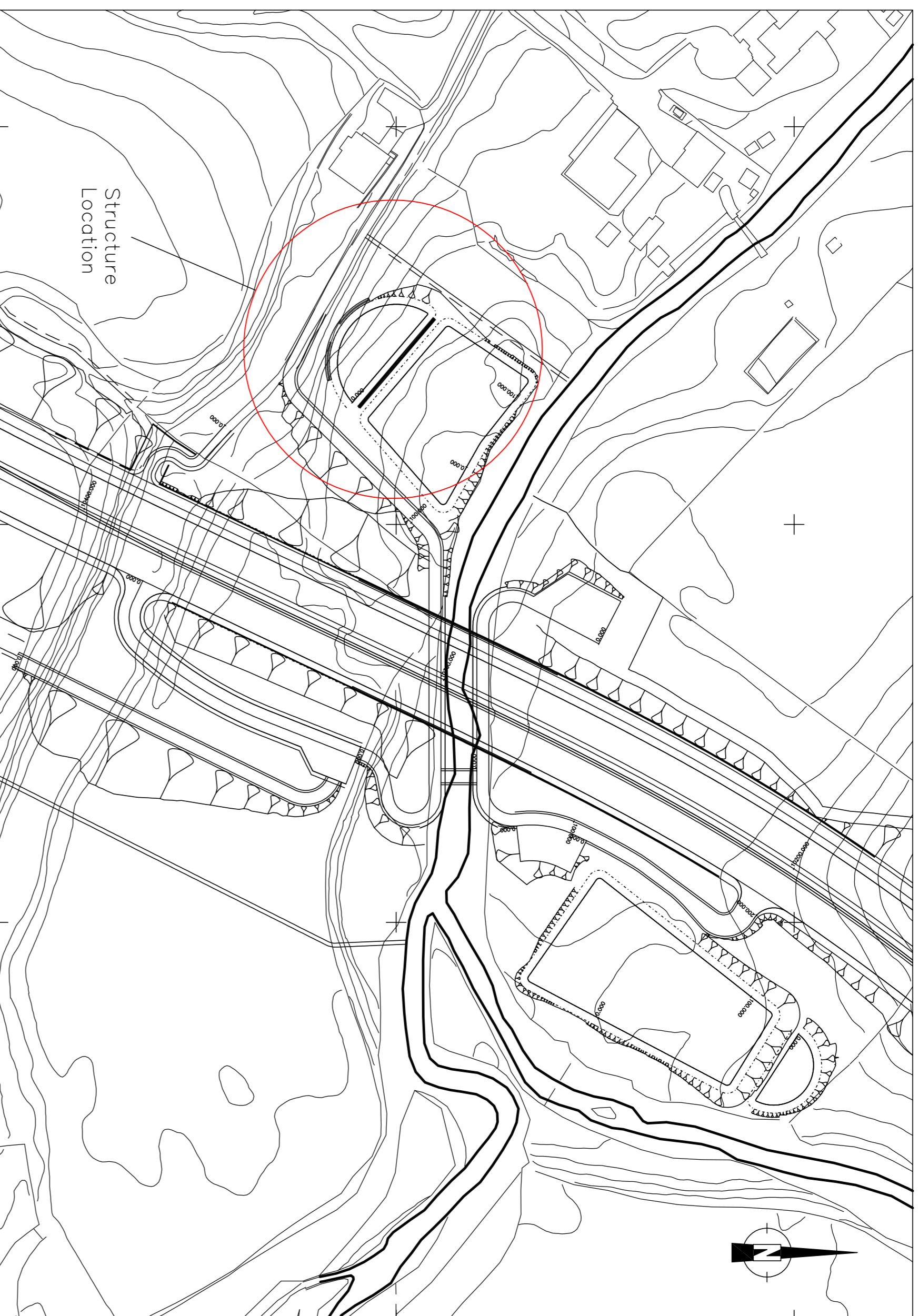

LOCATION PLAN
SCALE 1:1000

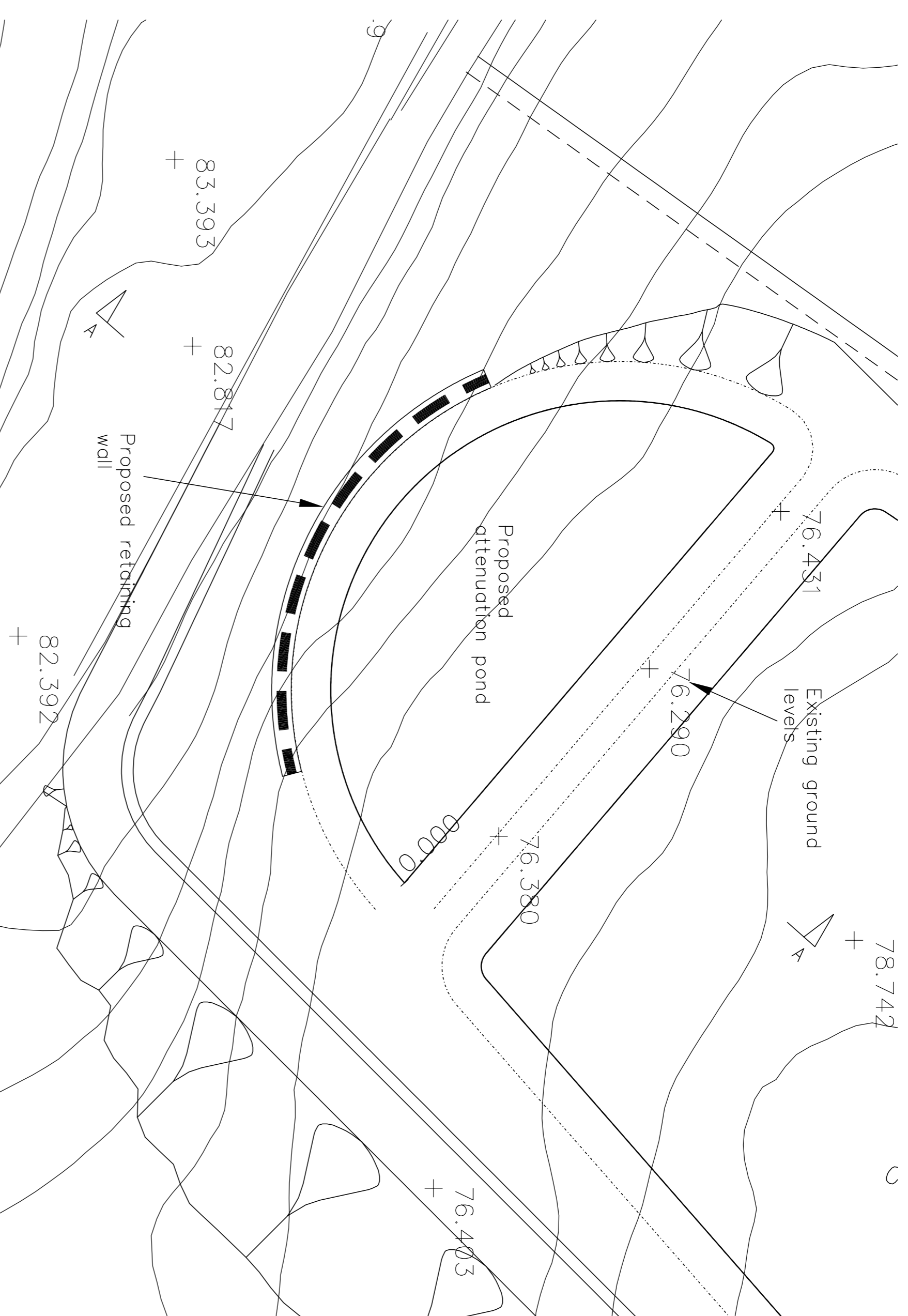

PLAN
SCALE 1:200

LENGTH OF WALL: 21m

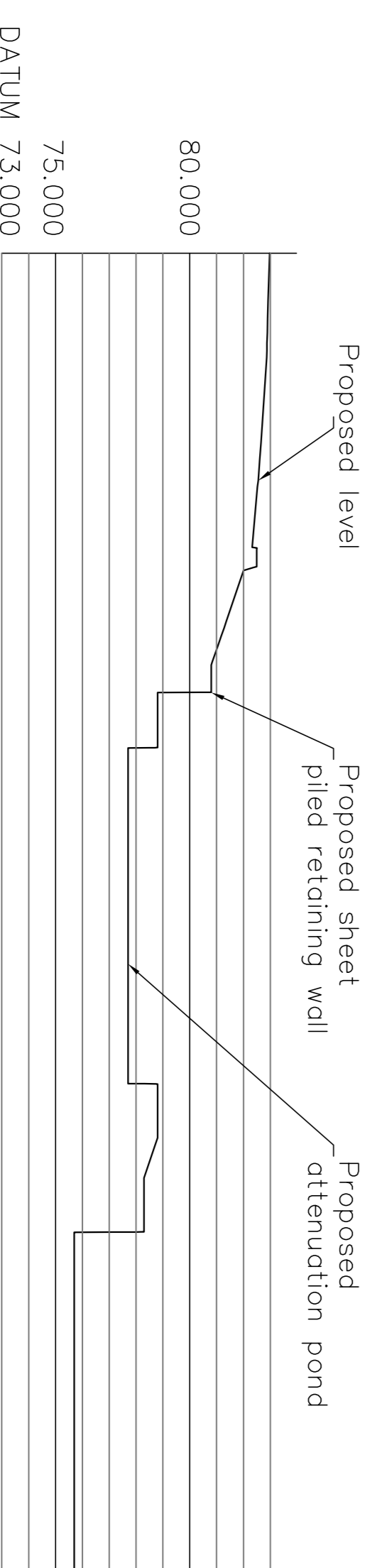

SECTION A-A
SCALE 1:200

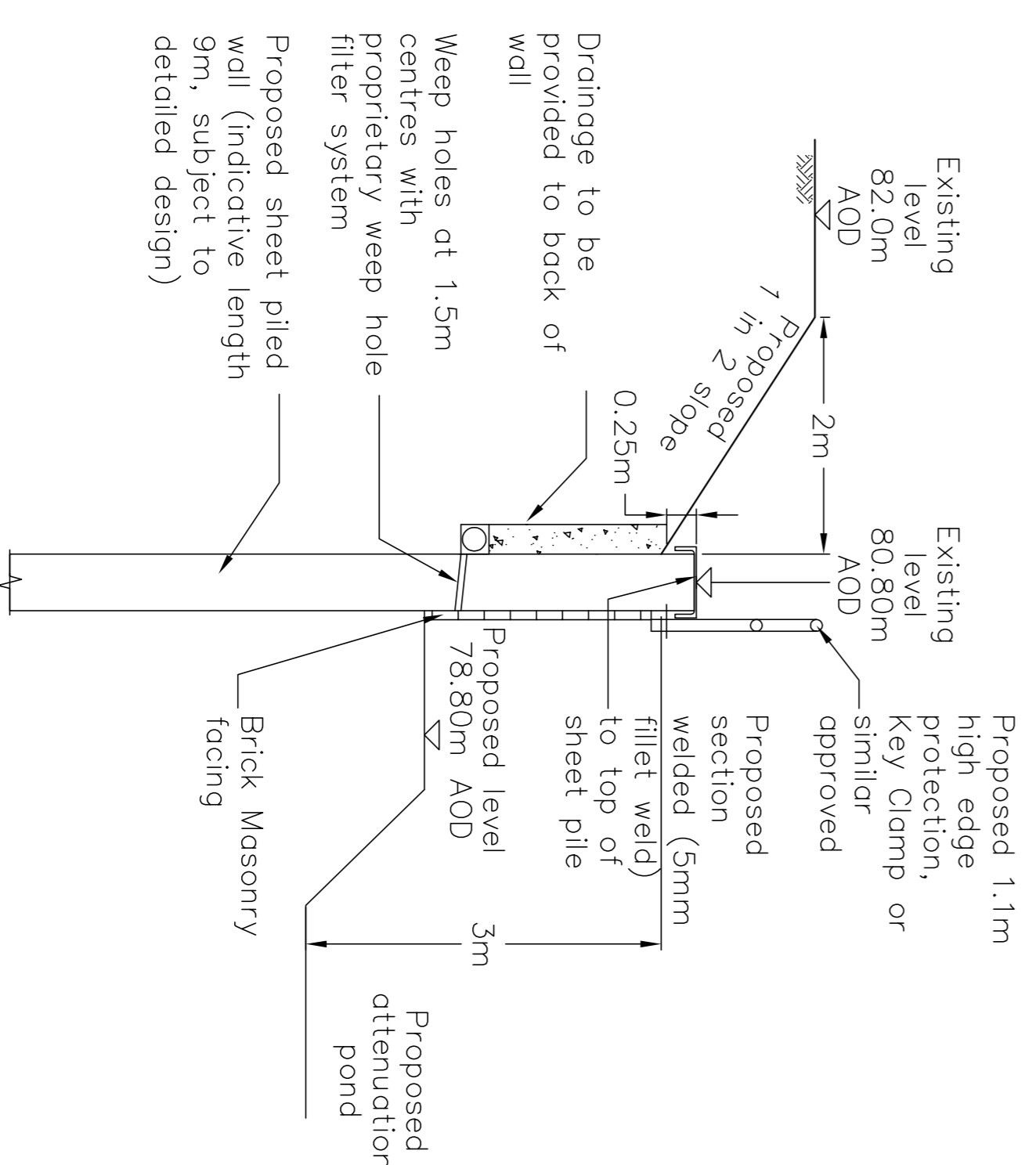

TYPICAL DETAIL OF SHEET PILED WALL
SCALE 1:20

Rev.	Drawn	Checked	Issue Date	Revision Details
A	DB	ME	13/09/13	Issued for Planning
-	DB	ME	30/08/13	First Issue

Drawn	Engineer	Checked	Approved
DB	DJ	ME	NS
Date	Date	Date	Date
AUG/13	AUG/13	AUG/13	SEP/13

Scale	Scale	AS SHOWN
A1	AS SHOWN	

SCNO	Revision No.	Revision
	1007/30/DF7/A6-MA/TR1B/003	A

<p>STOCKPORT MANCHESTER MIDLANDS</p>	<p>MANCHESTER CITY COUNCIL STATION HOUSE STATION ST MANCHESTER M2 2HT</p>
--	---

Job Title: **AG TO MANCHESTER AIRPORT RELIEF ROAD**

Drawing Title: **RETAINING WALL TR1B GENERAL ARRANGEMENT**